



CENTRIFUGAL JUICER CJ3000-2 USERS MANUAL



Contact Details:

DISTRIBUTED BY :

Canal Industrial and Trading Company Pty Ltd

P.O. Box 4418, Springfield Lakes, QLD4300, AUSTRALIA

Phone: +61 7 3103 7552 Fax: +61 7 3276 0529

Email: enquiries@canal.com.au

Web: www.canal.com.au

2001

Canal Industrial and Trading Company Pty Ltd

CENTRIFUGAL JUICER USERS MANUAL

CJ3000-2

Thank you for purchasing Canal's CJ3000-2 Centrifugal Juice Machine! To ensure you enjoy the full benefits of the Centrifugal Juicer's capabilities, we have provided this manual. In it you will find assembly, operating and cleaning instructions, safety information and a troubleshooting guide. Happy juicing!

Features

Canal's Centrifugal Juicer extracts delicious fresh juice from fruits and vegetables. The unique cutting blade design and powerful 750-watt motor enables effortless juice extraction for all types of fruit, vegetables and melons.

- ❑ Continuous juice production
- ❑ Automatic pulp ejection
- ❑ Simple, quiet and safe to operate
- ❑ Parts in Contact with juice are made of stainless steel
- ❑ Easy to dismantle and clean
- ❑ Produces up to 1.5 litres of juice in 30 seconds
- ❑ 8 different juice spout positions
- ❑ Thermal cutout motor protector

The Centrifugal Juicer is the perfect product to cater to today's health conscious public.

Troubleshooting Guide

Problem : No power to the Juice Machine.

- Check plugged into wall and power switch on.
- If Machine has been in prolonged use, the thermal cut out switch may have tripped. Turn off machine for 15 minutes and try again.

Problem : Juicer vibrates when operating.

- Remove the top cover and clean the basket of any residue.
- Ensure that the basket and bottom blade is properly positioned and that the blade securing nut is securely fastened.

All servicing should be carried out by suitably qualified personnel.

Cleaning Instructions

Before disassembling juicer for cleaning, switch power off and remove power plug from wall.

- 1) Undo the latches and remove the top cover.
- 2) Remove the blade securing nut by turning anti-clockwise with 22mm spanner.
- 3) Remove the bottom blade, basket and juice bowl.
- 4) Soak in dish washing detergent mixture. 4 Tablespoons of dish washing detergent in 5 litres of hot water. Rinse parts before they are reused.

Ensure parts are clean before use.
Do not clean Centrifugal Juicer parts in a dishwasher.

Specifications

CENTRIFUGAL JUICER

46 cm high
30 cm diameter base
29 kg weight
2800 rpm 750 watt motor
Supply Voltage 240 volts 50 Hz

Operating Instructions

WARNING : Only use the plunger provided to push fruit and vegetables down the main top cover opening. Keep hands clear of top cover openings. Never operate juicer unless the top cover is properly fitted.

- 1) Once the Centrifugal Juicer is properly assembled, switch the juicer on and off with the power switch on the juicer base. Always ensure the switch is in the off position before the power cord is plugged into the wall.
- 2) Fruit and Vegetables are fed into the machine through the large opening in the top cover and pushed down onto the blade with the plunger. Turn the machine on before putting fruit or vegetables down the opening in the top cover.
- 3) The juice is extracted through the tube protruding from the juice bowl. Pulp is ejected via the pulp duct.
- 4) After each juicing, the machine should be rinsed by pouring water through the large opening in the lid to remove any residue from the basket.

In the event that the machine vibrates, stop the machine, remove the lid and clean the basket to remove any residue.

Cut fruit and vegetables to a size that can easily fit into the main top cover opening. Remove hard seeds from fruit or vegetables before juicing (eg. Mangoes and Peaches).

Assembly Instructions

WARNING : Do not switch on the machine until it is properly assembled. Unplug power cable from wall during assembly.

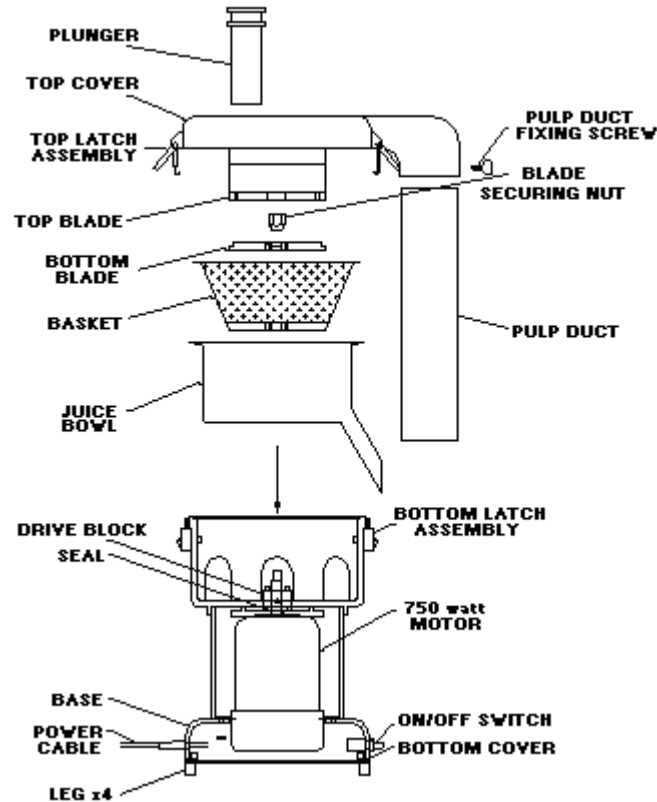

Figure 1. Centrifugal Juicer labeled assembly drawing.

- 1) Ensure the machine is positioned on a clean, flat surface.
- 2) The Juice Bowl should be sitting correctly in one of eight positions.
- 3) Fit the basket onto the drive block with both drive pins and motor shaft protruding through the holes in the bottom of the basket.
- 4) Carefully fit the bottom blade so that the drive block pins protruding through the bottom of the basket fit into the holes on the back of the blade. Make sure the bottom of the basket is clean before fitting blade.
- 5) Make sure the blade-securing nut is securely fastened. Use a 22mm spanner to tighten this nut.
- 6) The top cover may be fitted in two positions. Ensure that the two pins from the bottom latch assembly slot into the holes in the top cover before clamping the latches down. The latches should be firm but not over tight. The latches can be tightened by turning the hooks clockwise and loosened by turning them anti-clockwise.
- 7) Insert the pulp extraction duct into position at the side of the lid. Fasten using the pulp duct fixing screw.